

THO



Smiths Lane, Windsor
£599,950

OSBORNE HEATH



Downstairs there is a living and dining room, study that has been used as a fourth bedroom, kitchen with breakfast bar and a downstairs WC.

Upstairs there are three bedrooms, an en suite shower room to the principal bedroom, and a family bathroom.

To the front of the house is driveway parking and a double length garage. To the rear there is a long west facing garden with patio and lawn areas.

Smiths Lane is a residential road close to Dedworth Middle School and local shops. Windsor town centre has a wide range of shops and restaurants as well as Windsor Castle, Windsor Great Park, Windsor Racecourse and Legoland. Train stations include Windsor & Eton Central and Windsor & Eton Riverside where trains run to London Paddington (via Slough - Elizabeth Line) and London Waterloo, plus there is bus stop close by including the GoToGate bus service to Heathrow Terminal 5. The area has a selection of well-regarded schools close by including St Edwards, Clewer Green, Windsor Boys and Windsor Girls.

Smiths Lane
Windsor

- Three Bedrooms
- Two Bathrooms
- Study
- Semi-Detached
- Garage
- Driveway
- Long West Facing Garden

Council Tax band: D

Tenure: Freehold

EPC Energy Efficiency Rating: E

EPC Environmental Impact Rating: E



APPROXIMATE FLOOR AREA

House - 102.21 sq m - 1100 sq ft
Garage - 27.06 sq m - 291 sq ft
Total - 129.27 sq m - 1391 sq ft
(Gross Internal Area)



NOT TO SCALE
This plan is for illustration purposes only

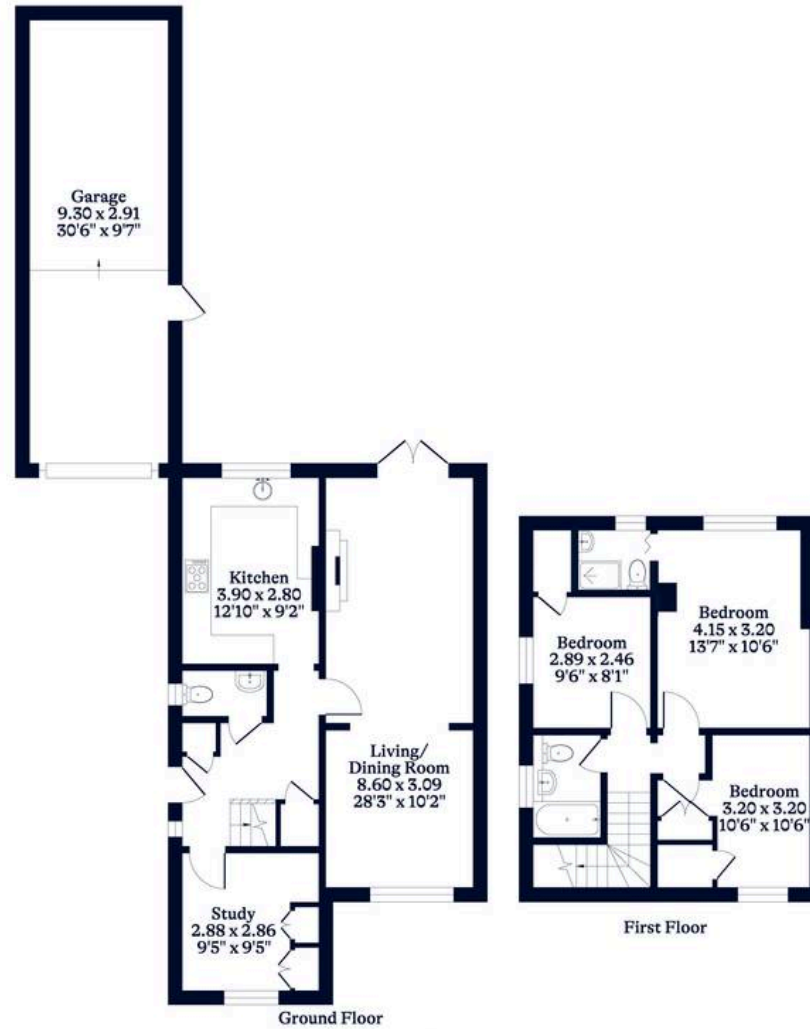

This plan is for layout guidance only. Not drawn to scale unless stated. Windows and door openings are approximate. Whilst every care is taken in the preparation of this plan, please check all dimensions, shapes and compass bearings before making any decisions reliant upon them.