



HIO

Osborne Road, Windsor
£365,000

OSBORNE HEATH



This refurbished first floor apartment has a living room with a balcony, kitchen, two bedrooms with built-in wardrobes, bathroom and storage.

The first floor can be accessed by lift or stairs, and this apartment has an allocated underground parking space. The development also has visitor parking and communal gardens.

Cornel House is a modern development off Balmoral Gardens, close to local shops and The Long Walk. Windsor also has Windsor Castle, The Great Park, Windsor Racecourse and Legoland. Nearby train stations include Windsor & Eton Central and Windsor & Eton Riverside where trains run to London Paddington (via Slough) and London Waterloo. Windsor is also convenient for the M4, M25, M40, M3 and Heathrow Airport.

Osborne Road

Windsor

- Two Bedrooms
- Refurbished
- Balcony
- First Floor
- Lift
- Parking
- Cul-De-Sac
- Close To Town Centre

Council Tax band: D

Tenure: Leasehold

EPC Energy Efficiency Rating: E

EPC Environmental Impact Rating: E

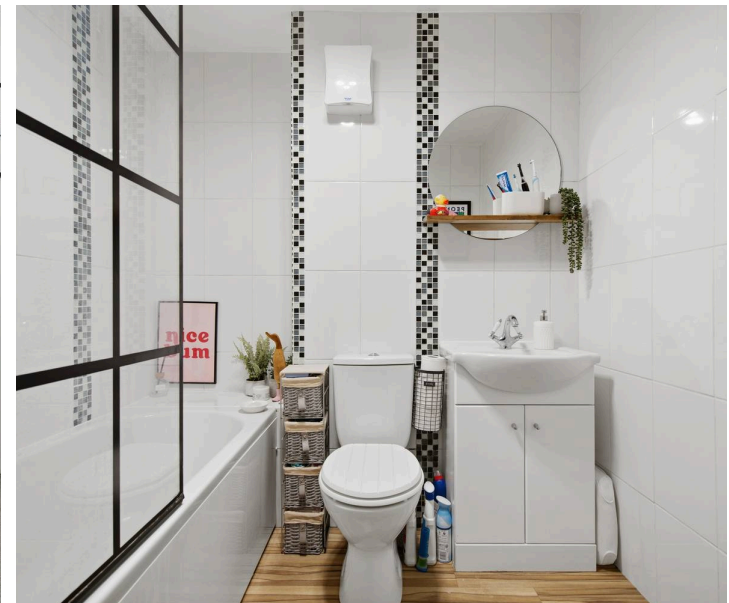

APPROXIMATE FLOOR AREA
Apartment - 67.00 sq m - 721 sq ft
(Gross Internal Area)

NOT TO SCALE
This plan is for illustration purposes only

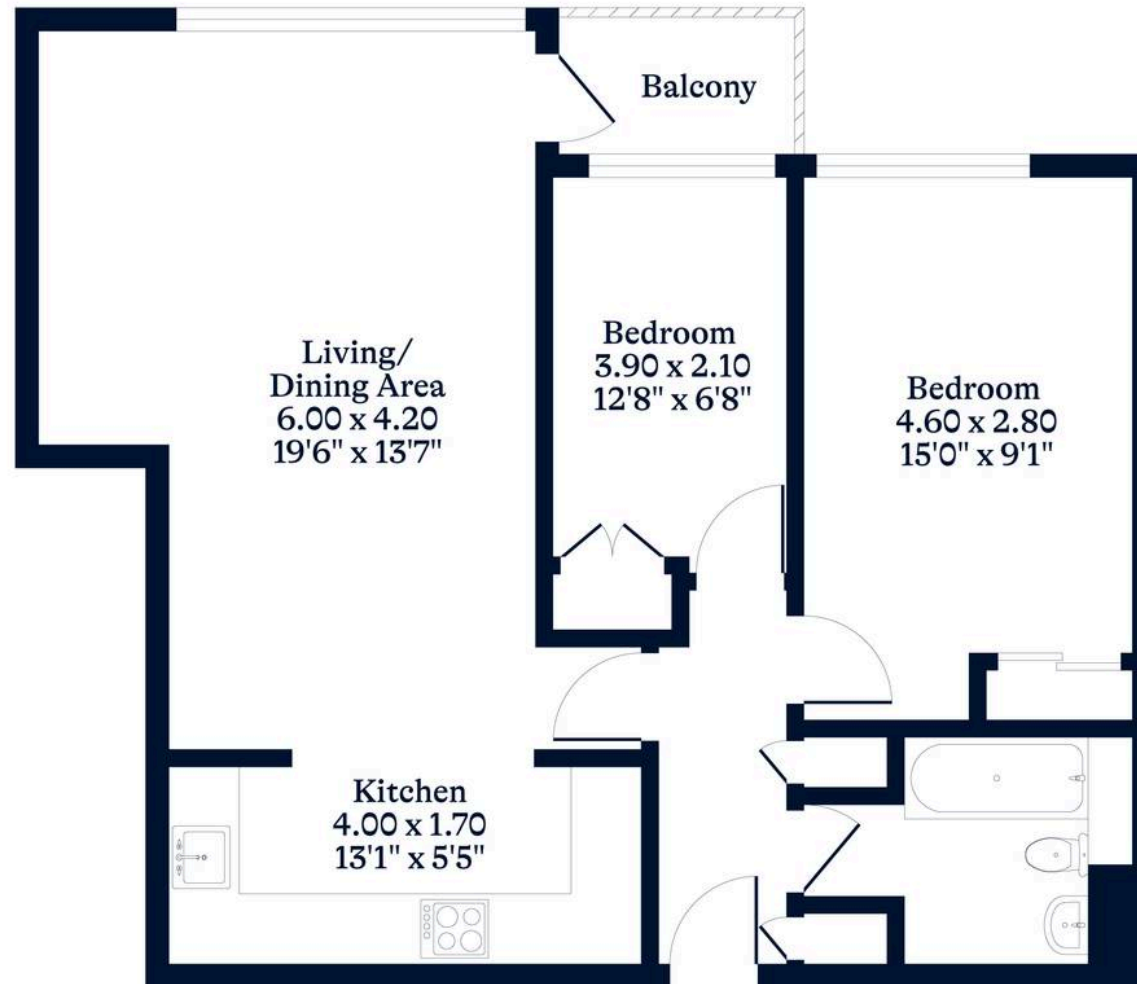

OSBORNEHEATH.CO.UK

This floor plan has been created by Property Shoot Ltd following the RICS code of measuring and is for indicative guidance only. Whilst every attempt has been made to ensure the accuracy of the floor plan contained here, measurements of doors, windows and rooms are approximate and no responsibility is taken for any error, omission or misstatement. Details shown on this floorplan, including all measurements, areas and proportions cannot be guaranteed by either the provider or estate agency and should not be relied upon.