



HIO

Russell Street, Windsor  
£2,750 pcm

OSBORNE HEATH



The ground floor has a living room with custom built media units, kitchen with an electric AGA and breakfast bar, and a utility room.

On the first floor is the principal bedroom with an en suite shower room, a double bedroom with built-in storage, a third bedroom or dressing room, and a family bathroom.

Outside there is a south facing courtyard that features a painted mural.

Russell Street is situated in the heart of Windsor town centre, just off St Leonards Road. Windsor has a wide range of shops and restaurants as well as the Castle, Great Park, Racecourse and Legoland. Nearby train stations include Windsor & Eton Central and Windsor & Eton Riverside where trains run to London Paddington (via Slough - Elizabeth Line) and London Waterloo. Nearby schools include Eton, The Kings House, Oakfield, The Queen Anne, St Edwards, Trevelyan, Trinity St Stephen, Upton House, Windsor Boys and Windsor Girls. Windsor is also convenient for the M4, M25 and Heathrow Airport

# Russell Street

Windsor

- Three Bedrooms
- Two Bathrooms
- End Of Terrace
- Electric AGA Cooker
- Utility Room
- South Facing Courtyard
- Town Centre Location

Council Tax band: D

Tenure: Freehold

EPC Energy Efficiency Rating: D

EPC Environmental Impact Rating:



**APPROXIMATE FLOOR AREA**  
House - 89.30 sq m - 961 sq ft  
(Gross Internal Area)



**NOT TO SCALE**  
This plan is for illustration purposes only

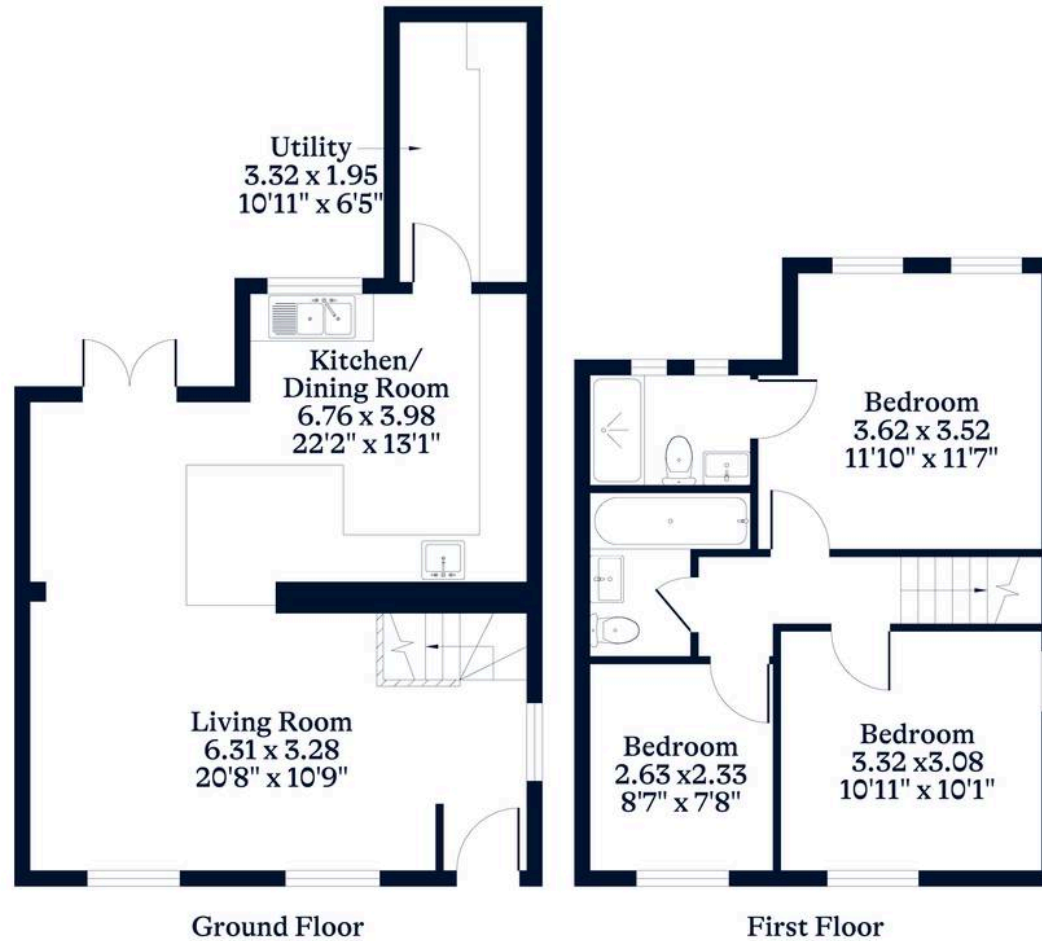

This plan is for layout guidance only. Not drawn to scale unless stated. Windows and door openings are approximate. Whilst every care is taken in the preparation of this plan, please check all dimensions, shapes and compass bearings before making any decisions reliant upon them.