



THO

Prince Andrew Way, Ascot  
£2,350 PCM

OSBORNE HEATH



The ground floor has a living room, kitchen, dining room, and a bathroom.

On the first floor there are three bedrooms and an en suite shower room.

Outside the property has a driveway, garage and side access leading to a south east facing garden.

Prince Andrew way is located off Fernbank Road. The nearest train station is Ascot where services run to London, Reading and Guildford. By road Ascot is convenient for the M3, M4, M25 and Heathrow Airport. Local places of interest include Ascot Racecourse, Coworth Park, Guards Polo Club, Legoland, The Lexicon, Sunningdale Golf Club, Wentworth Club and Windsor Great Park. Nearby schools include Ascot Heath, Charters, Cheapside, LVS, Papplewick and St. Francis.

# Prince Andrew Way

Ascot

- Three Bedrooms
- Two Bathrooms
- Driveway
- Garage
- South East Facing Garden
- Cul-De-Sac
- No Onward Chain

Council Tax band: D

Tenure: Freehold

EPC Energy Efficiency Rating: D

EPC Environmental Impact Rating: D



**APPROXIMATE FLOOR AREA**

House - 82.40 sq m - 887 sq ft  
Garage - 12.11 sq m - 130 sq ft  
Total - 94.51 sq m - 1017 sq ft  
(Gross Internal Area)

**NOT TO SCALE**  
This plan is for illustration purposes only

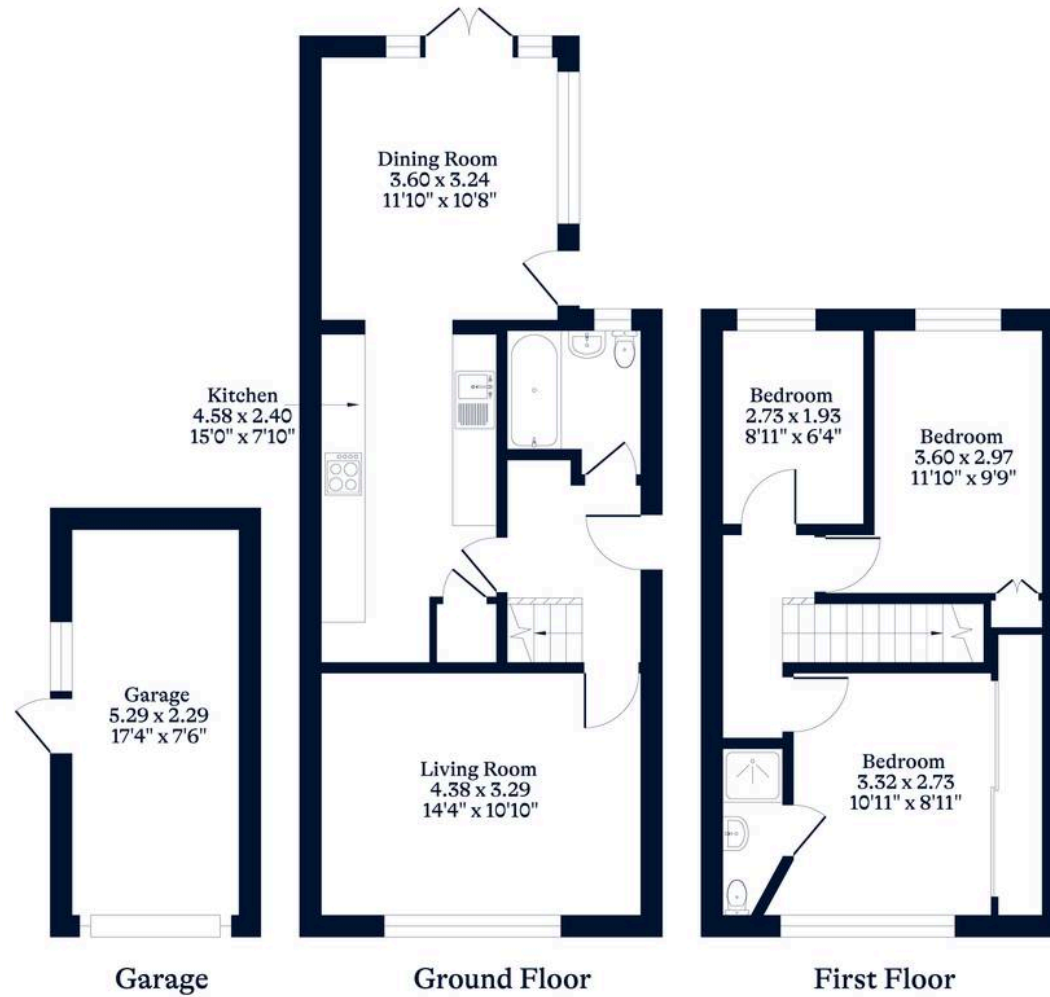

This plan is for layout guidance only. Not drawn to scale unless stated. Windows and door openings are approximate. Whilst every care is taken in the preparation of this plan, please check all dimensions, shapes and compass bearings before making any decisions reliant upon them.