

OIH



Mountbatten Square, Windsor
Offers Over £350,000

OSBORNE HEATH



This raised ground floor apartment has a living room with plantation shutters and a door out to the terrace, a separate kitchen, three bedrooms, modern shower room and a separate WC.

Outside there is a private south facing terrace with access to a large garage which has a parking space in front of it. The development also has gated parking and communal gardens.

Mountbatten Square is part of the Ward Royal development, originally opened by the late Queen Elizabeth II in 1969. Ward Royal is in Windsor town centre and residents have their own private entrance to Windsor Yards shopping centre. As well as shopping facilities, Windsor also has the Castle, Great Park, Racecourse and Legoland. Nearby train stations include Windsor & Eton Central and Windsor & Eton Riverside where trains run to London Paddington (via Slough) and London Waterloo. Windsor is also convenient for the M4, M25, M40, M3 and Heathrow Airport.

Mountbatten Square

Windsor

- Three Bedrooms
- Modern Kitchen
- Modern Bathroom
- South Facing Terrace
- Garage
- Gated Parking
- Communal Gardens
- Close To Shops
- Close To Station
- No Onward Chain

Council Tax band: C

Tenure: Leasehold

Lease: 80 years remaining

Service Charge: £1,441 pa

Ground Rent: £10 pa

EPC Energy Efficiency Rating: D

EPC Environmental Impact Rating: D





APPROXIMATE FLOOR AREA
Apartment - 67.13 sq m - 723 sq ft
Garage - 16.96 sq m - 183 sq ft
Total - 84.09 sq m - 906 sq ft
(Gross Internal Area)

NOT TO SCALE
This plan is for illustration purposes only

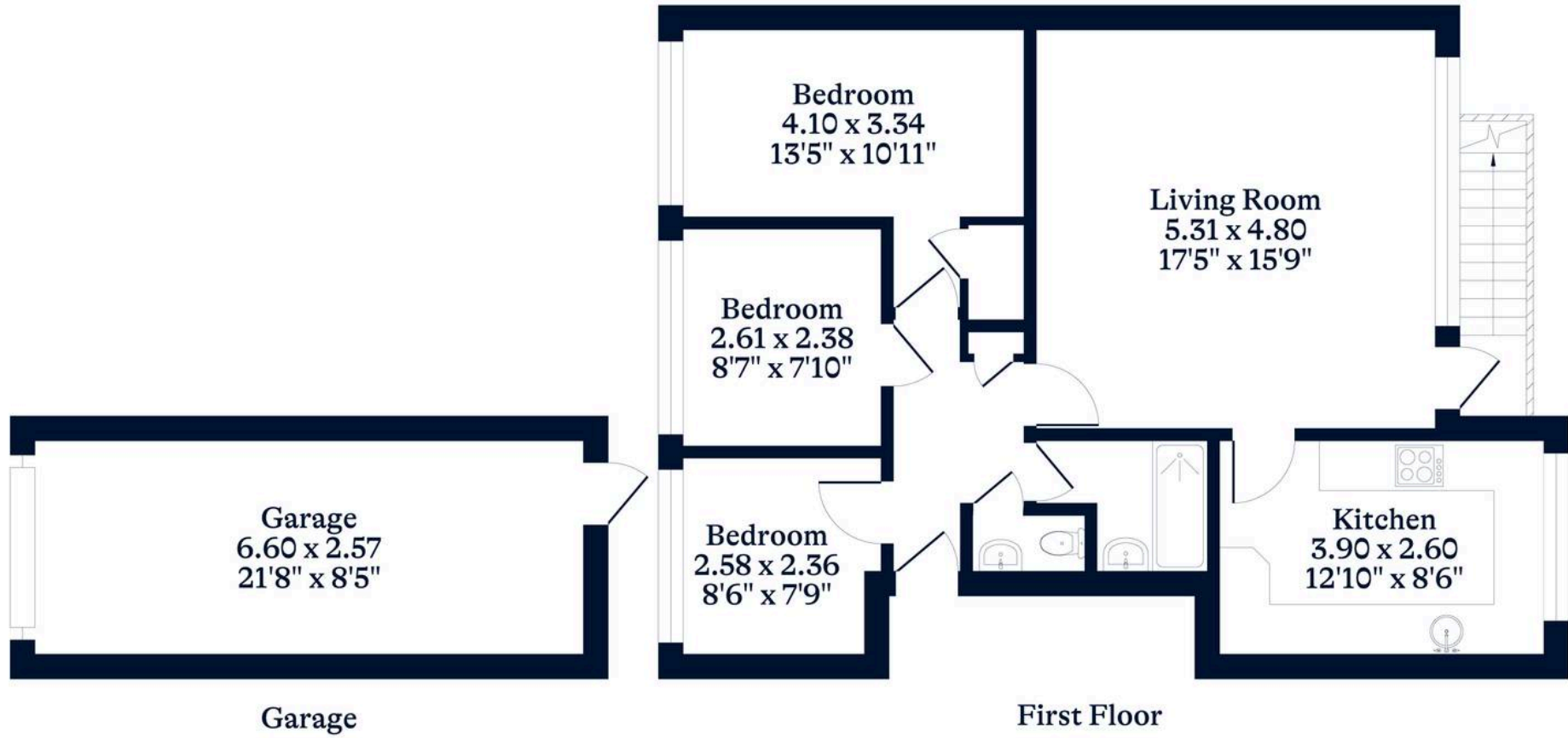

This plan is for layout guidance only. Not drawn to scale unless stated. Windows and door openings are approximate. Whilst every care is taken in the preparation of this plan, please check all dimensions, shapes and compass bearings before making any decisions reliant upon them.