

 4  4  3



Montagu Road, *Datchet*

OSBORNE HEATH

A spacious four double bedroom, three bathroom character home with a driveway and self-contained annexe, in a cul-de-sac close to the train station.

Downstairs there is a spacious double reception rooms with French doors leading out to the west facing garden, separate dining room with original wood panelling and a separate kitchen. There is a self-contained studio in the garden complete with a bedroom, shower room and additional room, perfect for a gym or study which can also be accessed via the kitchen and utility room.

Upstairs there are four double bedrooms, a four piece family bathroom and brand new en suite shower room.

Outside there is a driveway, large west facing garden with patio and lawn, plus a garden shed.

Montagu Road is a cul-de-sac close to Datchet train station where services run to London and Windsor & Eton Riverside. Nearby schools include Churchmead, Eton End and St Mary's. Local places of interest include Ascot Racecourse, Legoland, The Lexicon, River Thames, Windsor Castle, Windsor Great Park and Windsor Racecourse. By road Datchet is convenient for Heathrow Airport, M4 and M25.

EPC rating E. Council Tax band G. Tenancy Length 12-36 Months. Deposit £4,038 Holding Deposit £807.





APPROXIMATE FLOOR AREA
House - 190.24 sq m - 2048 sq ft
(Gross Internal Area)



NOT TO SCALE
This plan is for illustration purposes only

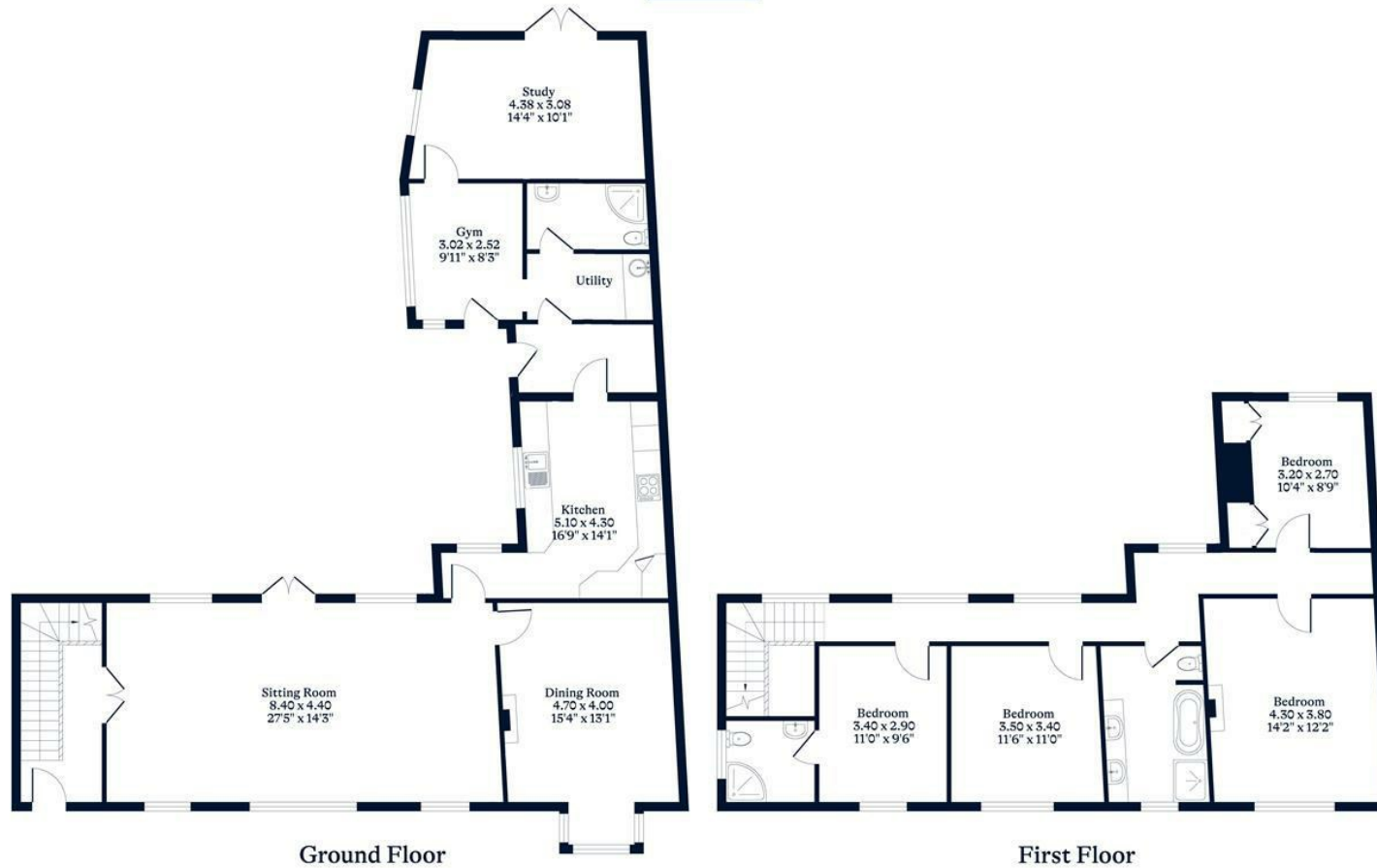

OSBORNEHEATH.CO.UK

This floor plan has been created by Property Shoot Ltd following the RICS code of measuring and is for indicative guidance only. Whilst every attempt has been made to ensure the accuracy of the floor plan contained here, measurements of doors, windows and rooms are approximate and no responsibility is taken for any error, omission or misstatement. Details shown on this floorplan, including all measurements, areas and proportions cannot be guaranteed by either the provider or estate agency and should not be relied upon.

©PROPERTYSHOOT