

 5  3  4



Murray Court, *Sunninghill*

OSBORNE HEATH

A five bedroom, four bathroom detached family home in a popular cul-de-sac in Sunninghill village with a driveway, garage, south facing garden and no onward chain.

On the ground floor there is a double-aspect living room, dining room, kitchen with dining space, downstairs WC and internal access to the garage.

The first floor has a principal bedroom with en suite shower room, two further en suite bedrooms, modern family bathroom and a two more bedrooms.

To the front of the house is a driveway with an EV charging point, plus side access to a south facing rear garden with lawn and patio areas.

Murray Court is a Charles Church built cul-de-sac in Sunninghill village. Nearby schools include Charters, St Francis, St Michael's and The Marist. The village has a number of local high street businesses and great restaurants and pubs. Nearby places of interest include Ascot Racecourse, Coworth Park, Guards Polo Club, Legoland, Wentworth Club, Windsor Castle and Windsor Great Park. The nearest train station is Ascot where services run to London, Reading and Guildford. Sunninghill is also convenient for the M3, M4, M25 and Heathrow Airport.

EPC rating D. Council Tax band G.





APPROXIMATE FLOOR AREA

House - 160.94 sq m - 1732 sq ft

Garage - 15.66 sq m - 169 sq ft

Total - 176.60 sq m - 1901 sq ft
(Gross Internal Area)

O
—
H

NOT TO SCALE

This plan is for illustration purposes only



First Floor

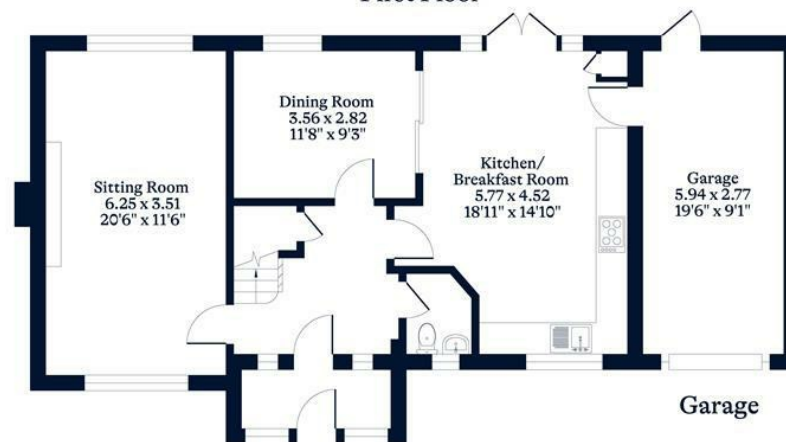

Ground Floor

This plan is for layout guidance only. Not drawn to scale unless stated. Windows and door openings are approximate. Whilst every care is taken in the preparation of this plan, please check all dimensions, shapes and compass bearings before making any decisions reliant upon them.

OSBORNEHEATH.CO.UK