

 3  3  2



Ringwood Close, *Ascot*

OSBORNE HEATH

A extended and modernised three bedroom, two bathroom link-detached property with driveway, close to Ascot train station and high street.

Downstairs there is an open-plan living room, dining area and kitchen which is centred around a feature central island, plus a study or playroom and a shower room.

Upstairs there are three bedrooms with built-in wardrobes and a family bathroom.

To the front of the houses is driveway parking, to the rear is the garden with patio and lawn areas.

Ringwood Close is in South Ascot Village close to Ascot train station where services run to London, Reading and Guildford. The local primary schools are South Ascot Village and St. Francis and the house is within Charters catchment area. Nearby places of interest include Ascot Racecourse, Coworth Park, Legoland, The Lexicon, Swinley Forest, Wentworth Club, Windsor Castle and Windsor Great Park. By road Ascot is convenient for the M3, M4, M25 and Heathrow Airport.

EPC rating C. Council Tax band E.





APPROXIMATE FLOOR AREA
House - 134.81 sq m - 1451 sq ft
(Gross Internal Area)

NOT TO SCALE
This plan is for illustration purposes only

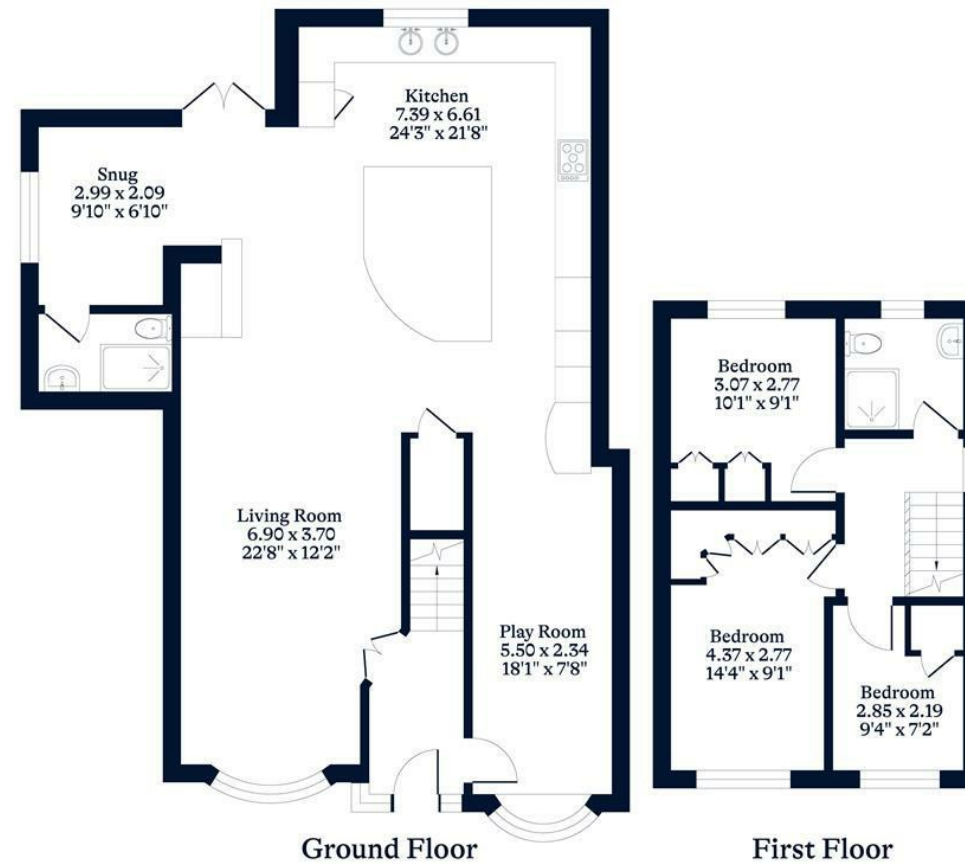

This plan is for layout guidance only. Not drawn to scale unless stated. Windows and door openings are approximate. Whilst every care is taken in the preparation of this plan, please check all dimensions, shapes and compass bearings before making any decisions reliant upon them.

OSBORNEHEATH.CO.UK