

 3  2  2



Convent Court, *Windsor*

OSBORNE HEATH

A three double bedroom, two bathroom split-level period conversion with gated parking, communal grounds and no onward chain.

Convent Court is a development of apartments converted from St John the Baptist Convent, and offers a wealth of character features, not only within this particular apartment, but throughout the whole development. There is a lift service and this apartment has high ceilings downstairs and vaulted ceilings upstairs.

The entry level has a large living area, with great views over communal grounds, leading through to a dining space and kitchen, plus a double bedroom and shower room. Spiral stairs lead to the principal bedroom with dressing room, bathroom and a guest room.

Convent Court is a gated development with expansive communal grounds including a central courtyard, and gated residents car parking.

The development is situated on Hatch Lane, close to local shops including Tesco Express. Windsor has a wide range of shops and restaurants as well as Windsor Castle, Windsor Great Park, Windsor Racecourse and Legoland. Train stations include Windsor & Eton Central and Windsor & Eton Riverside where trains run to London Paddington (via Slough - Elizabeth Line) and London Waterloo. The area has a selection of well-regarded schools close by including St Edwards, Clewer Green, Windsor Boys and Windsor Girls.

EPC rating E. Council Tax band F. Lease remaining 104 years. Service Charge £6,177 pa. Ground Rent 250 pa.





APPROXIMATE FLOOR AREA
House - 106.30 sq m - 1144 sq ft
(Gross Internal Area)



NOT TO SCALE
This plan is for illustration purposes only

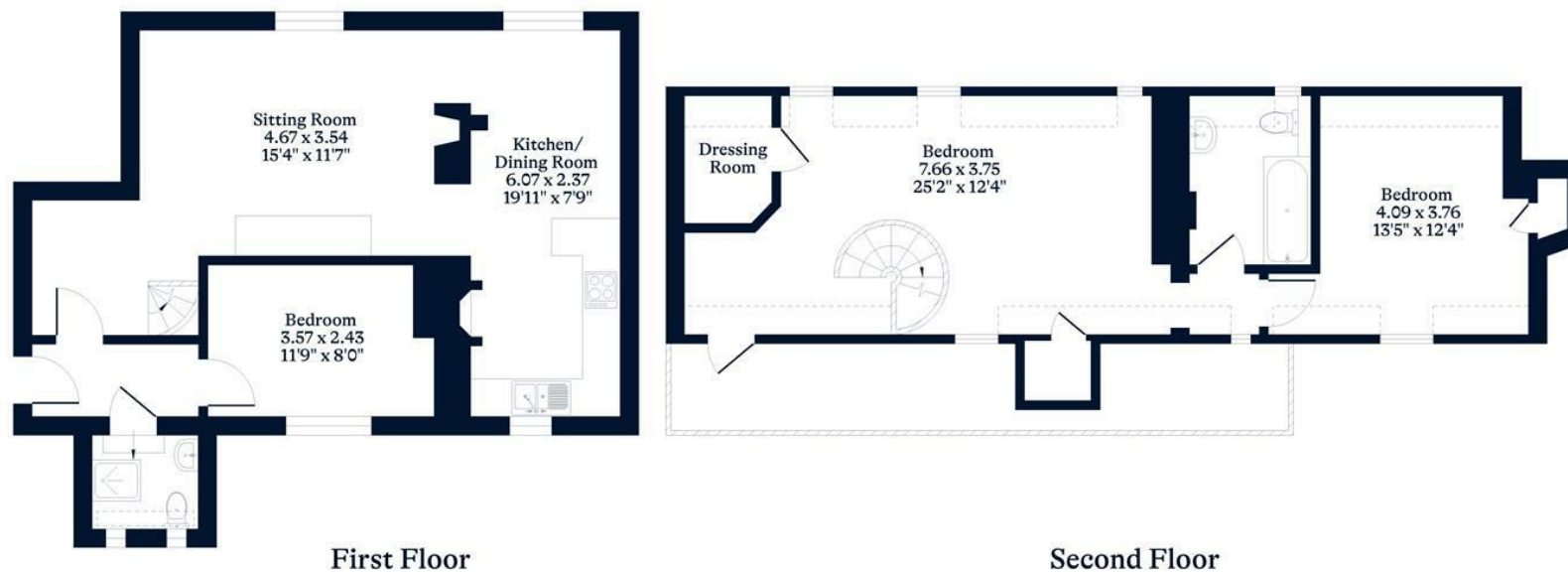

This plan is for layout guidance only. Not drawn to scale unless stated. Windows and door openings are approximate. Whilst every care is taken in the preparation of this plan, please check all dimensions, shapes and compass bearings before making any decisions reliant upon them.

OSBORNEHEATH.CO.UK