

 3  3  3



# Bell View, *Windsor*

OSBORNE HEATH



# A detached three double bedroom, three bathroom home with a driveway, garage, south east facing garden backing onto allotments and no onward chain.

Originally built as a bungalow, this detached home has been extended to the rear and into the loft to create three double bedrooms, three bathrooms and three reception areas. The property sits on a large corner plot therefore there is potential for further extensions, subject to planning.

The ground floor has a double reception with living and dining areas leading out to the garden, kitchen with dining space, bathroom and a downstairs double bedroom with built-in wardrobes and an en suite shower room.

Upstairs there is a shower room plus two double bedrooms, one with a view of Windsor Castle. There is potential to extend further subject to planning permission.

Outside there is driveway parking for several vehicles, a garage, outbuilding with power and a south east facing garden backing onto allotments.

Bell View is situated in a sought after location, close to local shops. Windsor town centre has a wide range of shops and restaurants as well as Windsor Castle, Windsor Great Park, Windsor Racecourse and Legoland. Train stations include Windsor & Eton Central and Windsor & Eton Riverside where trains run to London Paddington (via Slough - Elizabeth Line) and London Waterloo. The area has a selection of well-regarded schools close by including St Edwards, Clewer Green, Windsor Boys and Windsor Girls.

EPC rating D. Council Tax band E.









#### APPROXIMATE FLOOR AREA

House - 133.57 sq m - 1438 sq ft  
Garage - 23.29 sq m - 251 sq ft  
Total - 156.86 sq m - 1689 sq ft  
(Gross Internal Area)



#### NOT TO SCALE

This plan is for illustration purposes only

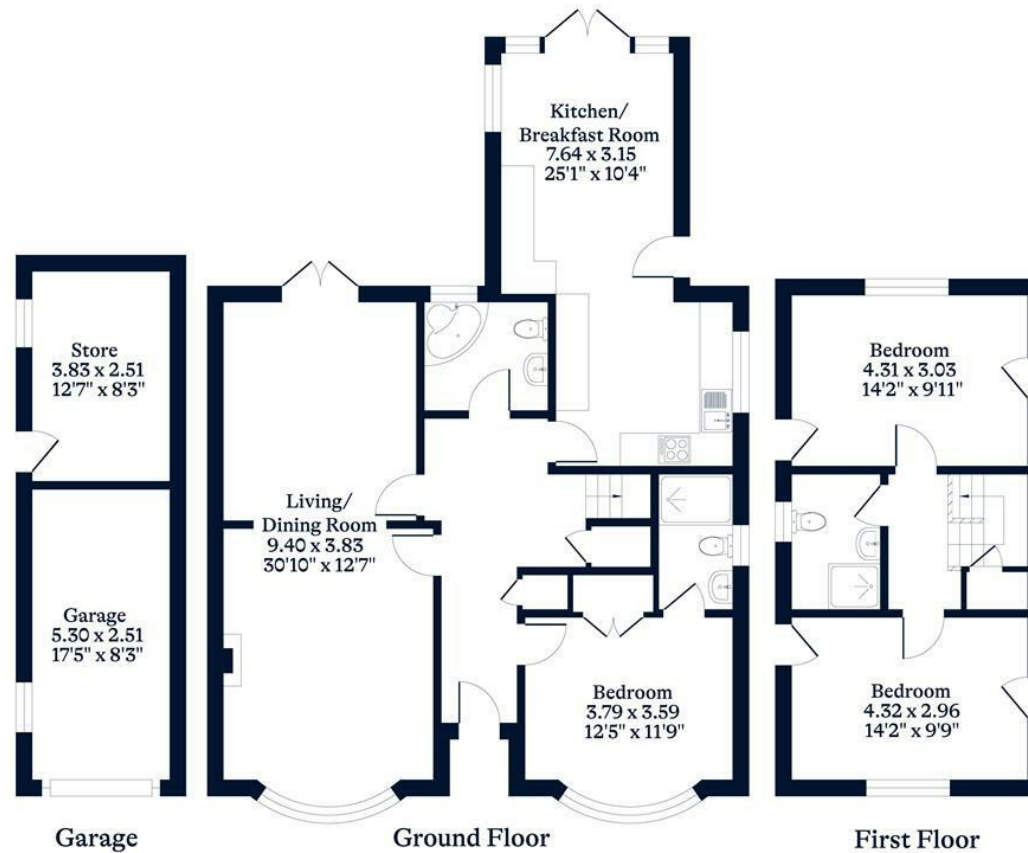

This plan is for layout guidance only. Not drawn to scale unless stated. Windows and door openings are approximate. Whilst every care is taken in the preparation of this plan, please check all dimensions, shapes and compass bearings before making any decisions reliant upon them.

[OSBORNEHEATH.CO.UK](http://OSBORNEHEATH.CO.UK)