

 4  3  3



O  
|  
H

# Withey Close, *Windsor*

OSBORNE HEATH



# A large four bedroom detached family house situated on a 1/3 acre plot with three reception rooms, three bathrooms and off road parking for numerous cars.

On the ground floor there is a living room with doors leading out into the garden, sitting room, dining room, kitchen/breakfast room, shower room, conservatory, and a downstairs WC.

The first floor has a principal bedroom with a vaulted ceiling, feature window, walk-in wardrobe and an en suite shower room. There are three further bedrooms and a family bathroom.

To the front of the house is a block paved driveway providing off-road parking for numerous cars, EV charging point and access to a single garage. To the rear is a large garden that wraps around the property, with an expanse of lawn, various shrubs and trees, and a decked patio area.

The property is situated in a cul-de-sac on the sought after Laing estate, to the west of Windsor. There is a range of shopping facilities close by including Tesco and Aldi, with additional facilities in Windsor town centre. Windsor has a wide range of shops and restaurants as well as the Castle, Great Park, Racecourse and Legoland. Nearby train stations include Windsor & Eton Central and Windsor & Eton Riverside where trains run to London Paddington (via Slough) and London Waterloo, and there is bus stop close by including the GoToGate bus service to Heathrow Terminal 5. The area is well served by a number of state, private and international schools and there are various parks close by including Sutherland Grange. Windsor is also convenient for the M4, M25 and Heathrow Airport.

EPC rating D. Council Tax band F.









**APPROXIMATE FLOOR AREA**  
House - 189.33 sq m - 2038 sq ft  
Garage - 10.66 sq m - 115 sq ft  
Total - 200.00 sq m - 2153 sq ft  
(Gross Internal Area)



**NOT TO SCALE**  
This plan is for illustration purposes only

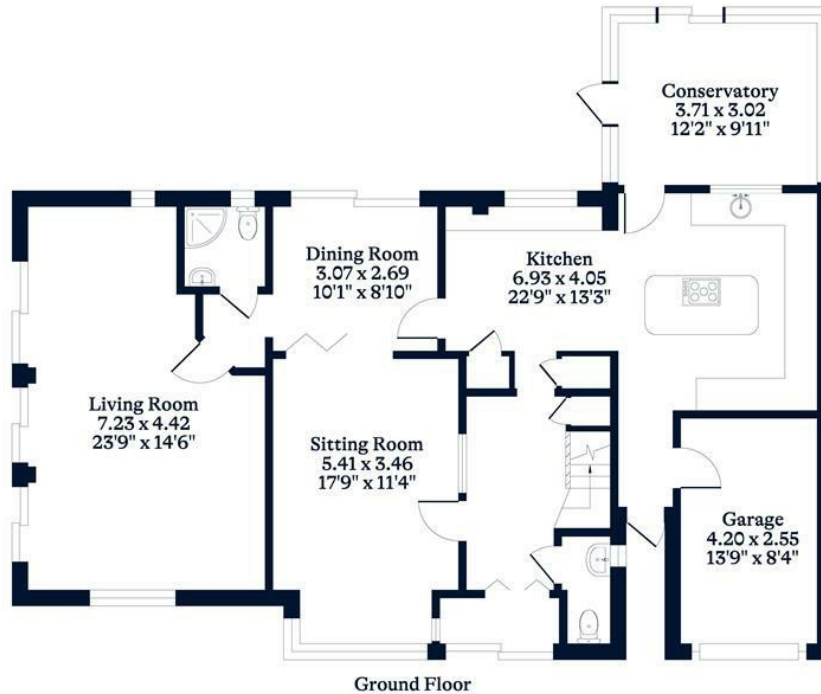

This plan is for layout guidance only. Not drawn to scale unless stated. Windows and door openings are approximate. Whilst every care is taken in the preparation of this plan, please check all dimensions, shapes and compass bearings before making any decisions reliant upon them.

[OSBORNEHEATH.CO.UK](http://OSBORNEHEATH.CO.UK)