

 4  3  2



Home Close, *Virginia Water*

OSBORNE HEATH

A four double bedroom, two bathroom detached house in a cul-de-sac, with a driveway and double garage.

Downstairs there is a living room with fireplace, dining room leading through to the conservatory, kitchen with space for a table and chairs, downstairs WC and integral access to the garage.

Upstairs there are four double bedrooms, an en suite shower room to the principal bedroom and a modern family bathroom.

Outside there is driveway parking, a double garage and side access to a secluded rear garden with lawn and decked areas.

Home Close is a small cul-de-sac within walking distance of Virginia Water train station where services run to London, Reading and Weybridge. Nearby schools include ACS, The Magna Carta, Manorcroft, Royal Holloway, St Ann's, Salesian, St Cuthbert's and Trumps Green. Home Close is close to the world famous Wentworth Club, and other local places of interest include Ascot Racecourse, Coworth Park, Guards Polo Club, The Savill Garden, Virginia Water Lake, Windsor Castle and Windsor Great Park. By road Virginia Water is convenient for the M3, M4, M25 and Heathrow Airport.

EPC rating C. Council Tax band G.





APPROXIMATE FLOOR AREA
House - 151.10 sq m - 1626 sq ft
Garage - 27.26 sq m - 293 sq ft
Total - 178.36 sq m - 1919 sq ft
(Gross Internal Area)



NOT TO SCALE
This plan is for illustration purposes only

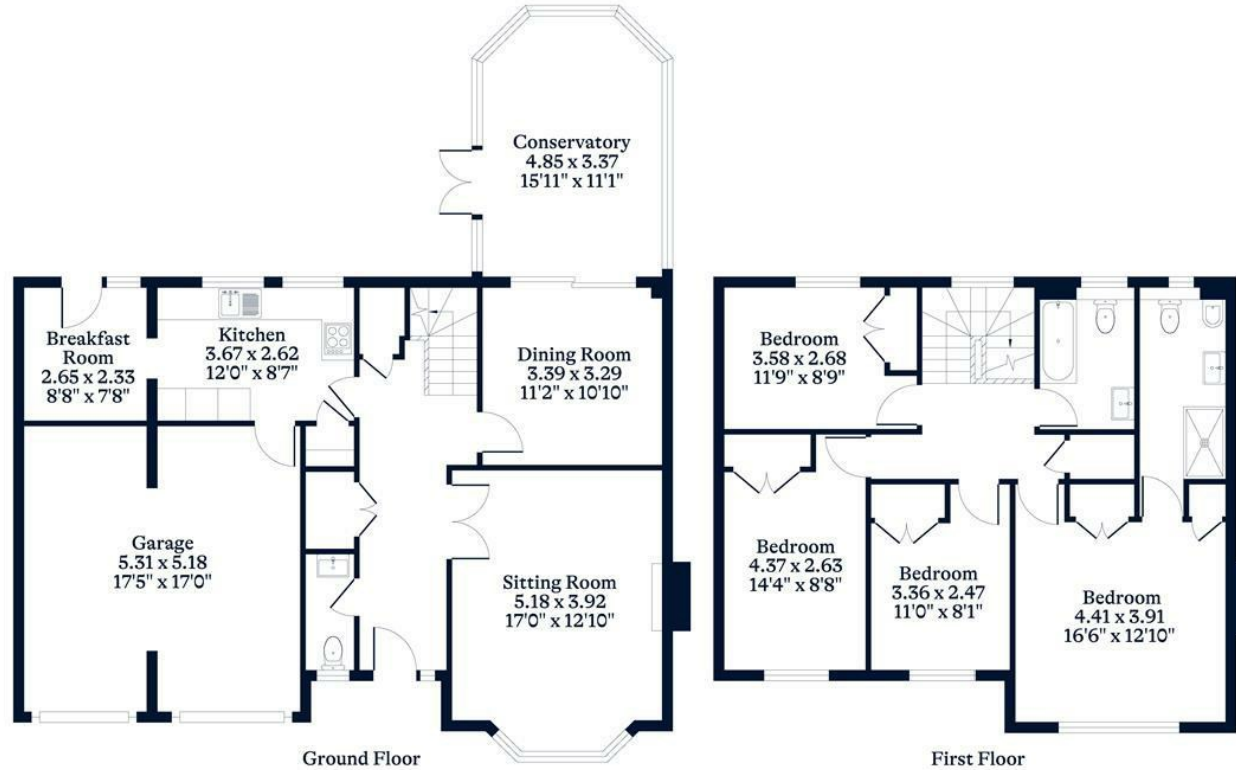

This plan is for layout guidance only. Not drawn to scale unless stated. Windows and door openings are approximate. Whilst every care is taken in the preparation of this plan, please check all dimensions, shapes and compass bearings before making any decisions reliant upon them.

OSBORNEHEATH.CO.UK