

 5  4  3



Wilton Crescent, *Windsor*

OSBORNE HEATH

A four bedroom detached house in a cul-de-sac, with a self-contained one bedroom annexe, west facing garden, double garage and no onward chain.

The ground floor has a living room, dining room, kitchen with utility area, study and a downstairs WC.

On the first floor there is the principal bedroom with en suite bathroom, three further bedrooms and a family shower room.

The self contained annexe has a reception room, kitchen, bedroom with en suite bathroom and an extra WC.

Outside there is a large front garden with driveway, double garage and side access to the rear garden and annexe. The rear garden has a west facing aspect, an area of lawn, patio, garden pond and timber shed.

The property is situated in a cul-de-sac, to the west of Windsor. There is a range of shopping facilities close by, with additional facilities in Windsor town centre. Windsor has a wide range of shops and restaurants as well as the Castle, Great Park, Racecourse and Legoland. Nearby train stations include Windsor & Eton Central and Windsor & Eton Riverside where trains run to London Paddington (via Slough) and London Waterloo. Local schools include Braywood, The Kings House, Oakfield, The Queen Anne, St Edwards, Trevelyan, Trinity St Stephen, Upton House, Eton, Windsor Boys and Windsor Girls. Windsor is also convenient for the M4, M25 and Heathrow Airport.

EPC rating D. Council Tax band G.





APPROXIMATE FLOOR AREA
 House - 139.66 sq m - 1503 sq ft
 Garage - 24.77 sq m - 267 sq ft
 Outbuilding - 81.88 sq m - 881 sq ft
 Total - 246.31 sq m - 2651 sq ft
 (Gross Internal Area)



NOT TO SCALE
 This plan is for illustration purposes only

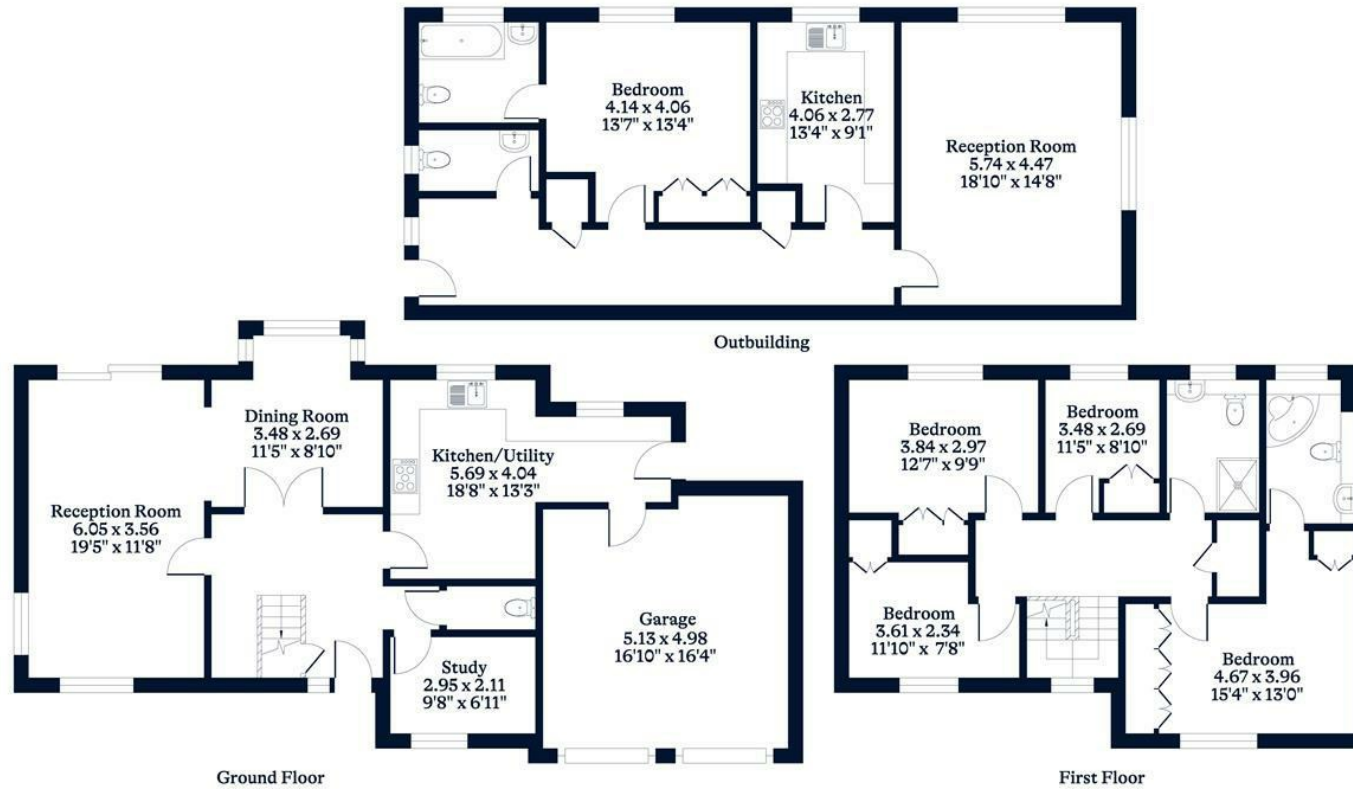

This plan is for layout guidance only. Not drawn to scale unless stated. Windows and door openings are approximate. Whilst every care is taken in the preparation of this plan, please check all dimensions, shapes and compass bearings before making any decisions reliant upon them.

OSBORNEHEATH.CO.UK