

3 1 1



Bridge Road, *Sunninghill*

OSBORNE HEATH

A three bedroom, semi-detached home with a south facing garden in the heart of Sunninghill village.

On the ground floor there is a living room, dining room, kitchen leading out to the south facing garden and a bathroom.

On the first floor there is two double bedrooms with a further bedroom attached.

Outside there is permit parking and a south facing rear garden with turf and decking.

Bridge Road is a cul-de-sac in the centre of Sunninghill village. Nearby schools include Charters, Holy Trinity, St Francis, St Michael's and The Marist. The village has a number of local high street businesses and great restaurants and pubs. Nearby places of interest include Ascot Racecourse, Coworth Park, Guards Polo Club, Legoland, The Lexicon, Wentworth Club and Windsor Great Park. Sunninghill is also convenient for the M3, M4, M25 and Heathrow Airport.

EPC rating E. Council Tax Band D. Deposit £2,134. Holding Deposit £426





APPROXIMATE FLOOR AREA
House - 78.25 sq m - 842 sq ft
(Gross Internal Area)

NOT TO SCALE
This plan is for illustration purposes only



First Floor

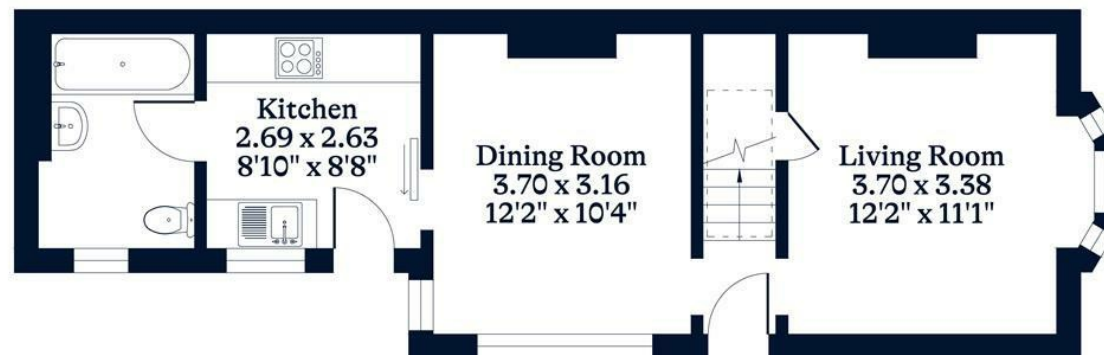

Ground Floor

This plan is for layout guidance only. Not drawn to scale unless stated. Windows and door openings are approximate. Whilst every care is taken in the preparation of this plan, please check all dimensions, shapes and compass bearings before making any decisions reliant upon them.

OSBORNEHEATH.CO.UK