

 1  1  1



Knights Place, *Windsor*

OSBORNE HEATH

A ground floor one bedroom apartment on the popular Knights Place development, conveniently close to Windsor town centre with two allocated, gated parking spaces.

This one bedroom apartment comprises an entrance hall, living room with Juliette balcony, open-plan kitchen, bedroom with built-in wardrobe and a white bathroom suite.

Outside, there is an attractive central courtyard and a secure undercroft garage with a allocated space plus visitor parking.

The apartment can be accessed via stairs or lifts from the undercroft garage or via the central courtyard.

Outside, there is an attractive central, approximately 0.5 miles from Windsor Town centre. Windsor has a wide range of shops and restaurants as well as the Castle, Great Park, Racecourse and Legoland. Nearby train stations include Windsor & Eton Central and Windsor & Eton Riverside where trains run to London Paddington (via Slough) and London Waterloo. Nearby schools include Eton, The Kings House, Oakfield, The Queen Anne, St Edwards, Trevelyan, Trinity St Stephen, Upton House, Windsor Boys and Windsor Girls. Windsor is also convenient for the M4, M25 and Heathrow Airport.

EPC rating C. Council Tax Band D. Lease 12-36 months. Deposit £1,442.





APPROXIMATE FLOOR AREA
House - 40.40 sq m - 435 sq ft
(Gross Internal Area)



NOT TO SCALE
This plan is for illustration purposes only

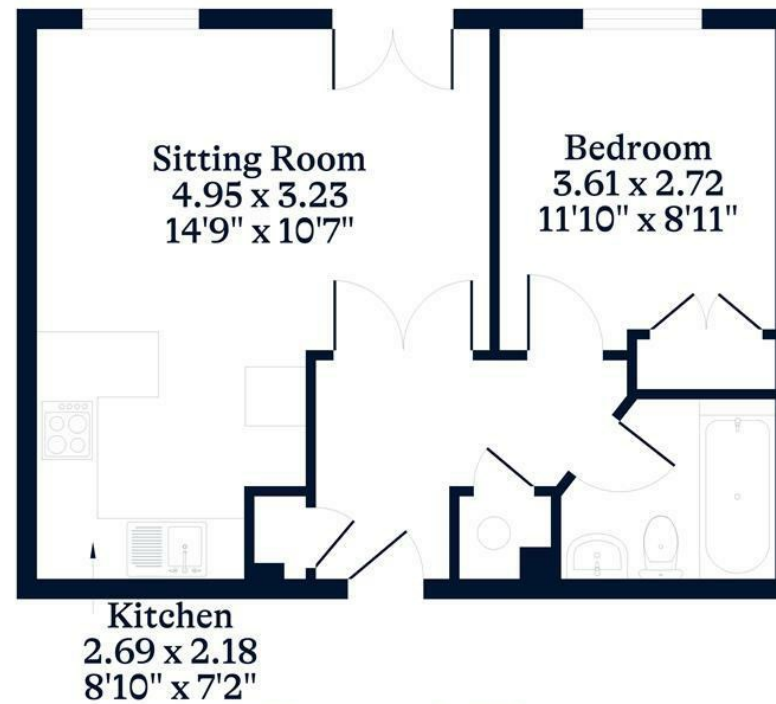

Ground Floor

This plan is for layout guidance only. Not drawn to scale unless stated. Windows and door openings are approximate. Whilst every care is taken in the preparation of this plan, please check all dimensions, shapes and compass bearings before making any decisions reliant upon them.

OSBORNEHEATH.CO.UK